

User instructions



Betty TK7 & TK8

Thau & Kallio

2021

Congratulations with your new Betty, designed in 2021 by Thau & Kallio. We hope you will enjoy using this product and follow these instructions to ensure correct assembly. If you have any questions or comments, please do not hesitate to contact us by mail on:

info@andtradition.com

Betty TK7 & TK8 Thau & Kallio 2021

Please read these instructions carefully and retain them for future reference to ensure that the product is used correctly. For your own safety, please study each step of this instruction manual first. &Tradition is not responsible for any faults or damages caused by not following these instructions correctly. Do not modify this product in any way.

Cleaning instructions

Steel

It is recommended only to use a soft dry cloth to clean plated and powder coated surfaces but in case more severe cleaning is necessary, a soft cloth wrung in lukewarm water can be carefully applied. Always dry immediately after cleaning with a soft dry cloth. Avoid using abrasive cleaning agents or aggressive cleaning detergents on lated or powder coated surfaces as this may permanently damage the surface.

Lacquered wood

For daily care it is recommended to dust the furniture with a soft cloth. Lacquered wood can be cleaned with a soft cloth wrung in a mild solution of lukewarm water and a universal cleaning detergent. Always follow the wood grains and always dry with a soft dry cloth immediately after cleaning. Avoid use of abrasive cleaning agents and aggressive cleaning tools such as steel wool, scouring pads or stiff brushes as this will damage the surface of the lacquered wood.

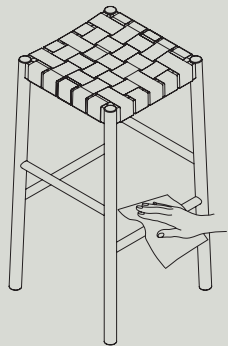

Steel footrest installation

Step 1

Wipe the stool footrest surface with the supplied alcohol swab for optimal attachment of the footrest protector. Be careful only to rub the surface where the footrest protector will be placed since the alcohol swab might wipe of some of the pigment in the lacquer.

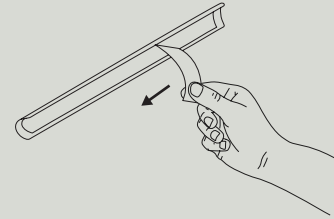

Step 2

Remove protective liner on the steel protector.

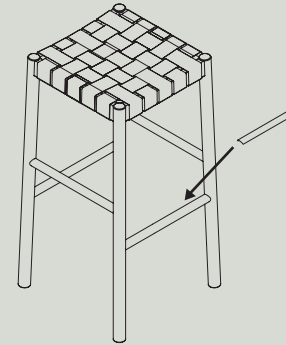

Step 3

Center and place the steel protector on the upper side of the footrest.

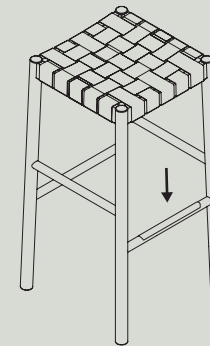

Step 4

Apply firm pressure until the steel protector is attached.

&Tradition®